

# HYVA DIVERTER VALVE



DIVERTER VALVE - PNEUMATIC OPERATING

Hyva

flipping valve type:

diverter valve VDMR

working pressure:

350 bar

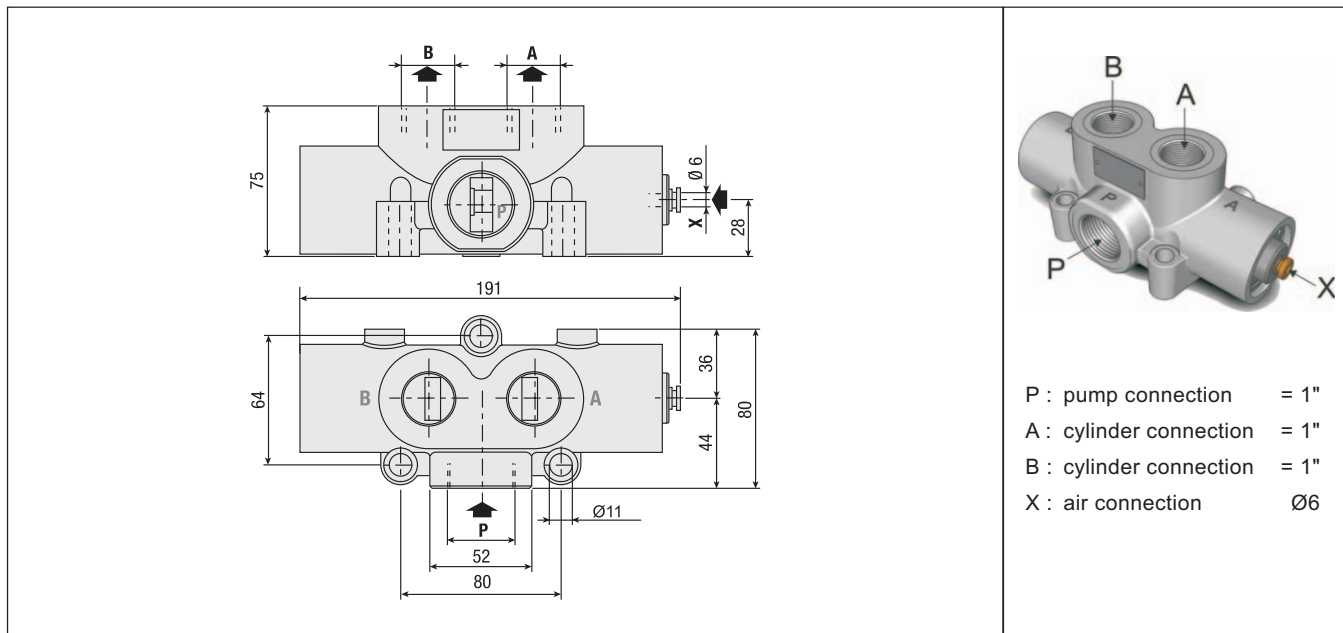

## specifications

type	: Two position pneumatic controlled diverter valve
hydraulic connections	: G1"
max. working pressure	: 350 bar
max. peak pressure	: 500 bar
max. pneumatic pressure	: 12 bar
max. advised flow	: 160-200 L/min. (see $\Delta p$ -Q characteristic)
filtration	: $\leq 25 \mu\text{m}$ (ISO 18/13)
oil types	: mineral oil (DIN 51524 / 51525)
viscosity range	: 12 / 100 mm <sup>2</sup> /s
temperature range	: -25 / + 80 °C
mass	: 3.3 kg

## general information

- This valve has to be normally piloted without oil flow.
- The work position has to be selected before operation begins.
- Mount the valve according to the Hyva mounting instructions.
- Use the correct washers and adapters in the ports to prevent housing deformation.
- Do not use adapters with tapered threads.
- To further prevent deformation of the valve housing, the mounting plate surface must be completely flat and plane.
- Do not weld to the valve.
- Max. torque for bolts to mount the valve is 15 Nm.
- When not used with air pressure on "X" connection, the hole should be connected to 60 cm free air hose to prevent water to enter air cylinder.
- Spool has negative overlap (during shifting all ports are briefly connected).

## $\Delta p$ - Q characteristic

Viscosity 30 mm<sup>2</sup>/s 50°C

This characteristic shows the pressure drop in relation to the flow.

pump to cylinder (P→A) & (P→B)

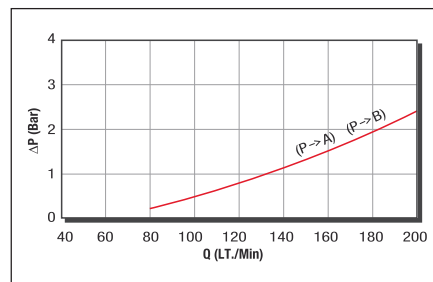

## hydraulic symbol

